

# FOR LEASE

393 Queen St., Acton, ON

## PRIME RETAIL PLAZA

**New Development at HWY 7 (Queen St.) and Tanners Drive, Acton, ON**



Michael Pearlman · Vice President · Sales Representative · O: (905) 607 0719

[pearlmanmichael@gmail.com](mailto:pearlmanmichael@gmail.com) · C: (416) 567 5101 [www.clearstreamcre.com](http://www.clearstreamcre.com)

# Site Features

393 Queen St., Acton, ON

## Honeyfield Plaza



Available Units from:  
1,212 square feet - 10,000 square feet

Honeyfield Plaza is located on the NW corner of Hwy 7 (Queen St. E.) and Tanners Drive in Acton, ON. Once complete, the centre will include approximately 12,700sf of retail.

Building B is now complete, and Building A is planned to be completed Fall 2020 and have approximately 10,000 square feet of leasable area.

The property is located directly across from the newly built Acton Community Centre / Arena.

### Details:

- Located on Hwy 7, Acton's primary artery connecting to Georgetown to the east and Guelph to the west.
- Development is located in the Acton Highway 7 east retail node that includes Sobey's, No Frills, Rexall, McDonalds and RBC along with several other national retailers located in close proximity to the subject property.
- Located adjacent to several hundred newer homes built.
- Building B is now leased with Pita Pit and Twice the Deal Pizza (Division of Gino's), and Magic Nails.
- Building A Units range in size from approximately 1,280sf to 10,000sf
- Units in Building A start at \$28.00sf triple net
- Additional Rent: Operating Costs estimated at \$3.90sf + property taxes estimated at \$9.90sf



# Site Plan

393 Queen St., Acton, ON

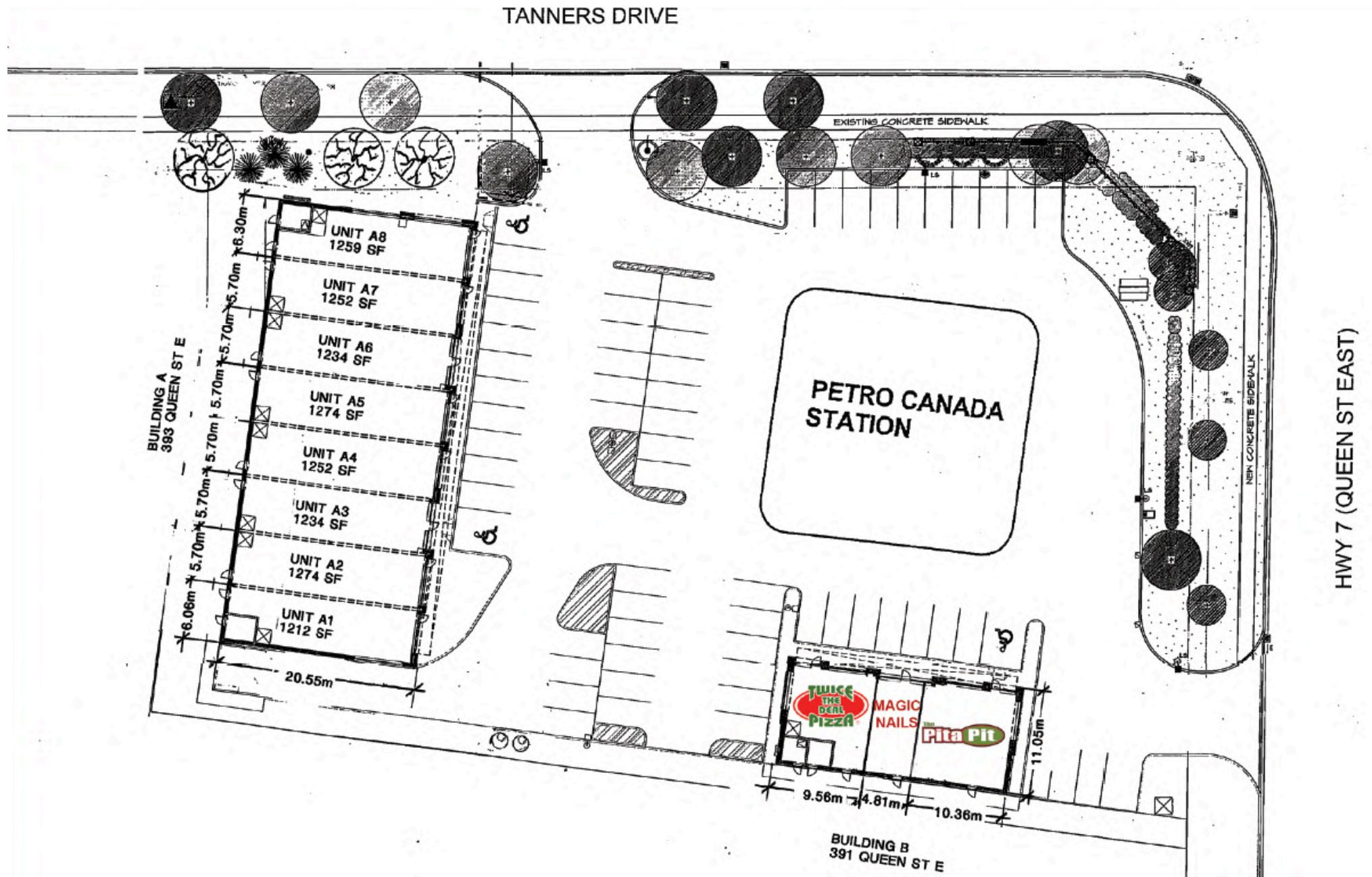



# Site Overview

393 Queen St., Acton, ON





# Demographics

393 Queen St., Acton, ON

## Demographic Overview



## DEMOGRAPHIC SNAPSHOT

	3K	5K
Total Population	10,344	12,765
Households	3,845	4,690
Average Age	39	39
Average Household Income	\$100,449	\$107,042

### Retail Landscape (Trade Area)

